

SAFETY EXHAUST WITH LOCKOUT HANDLES O.S.H.A. APPROVED

SPECIFICATIONS:

- **Pressure Rating:** 125 PSI air
- **Temp. Range:** 40°F to 140°F
- Two piece, Full port valve w/ threaded ends
- **Handle:** Tamper proof lockout feature locks in the closed position only.
- Exhaust port is tapped 10-32 UNF thread for mounting mufflers or to direct air.
- Complies with O.S.H.A. Standard 1910.147

HOW IT WORKS

When the handle is in the off position, the exhaust vents residual air on the downstream side of the valve. This ensures that air powered equipment is safe to service.

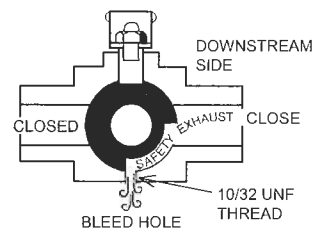
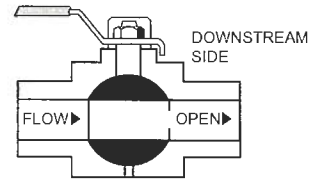
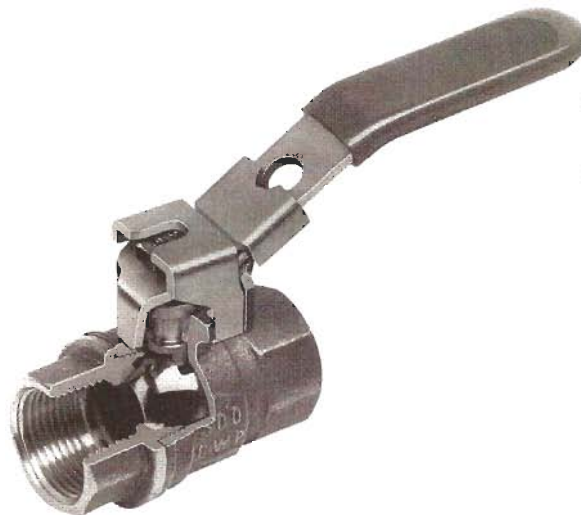

STANDARD VALVE

SPECIFICATIONS:

- **Pressure Rating:** 600 PSI CWP/150 PSI WSP
- **Temp. Range:** -20°F to 370°F
- Two piece, Full port valve w/ threaded ends

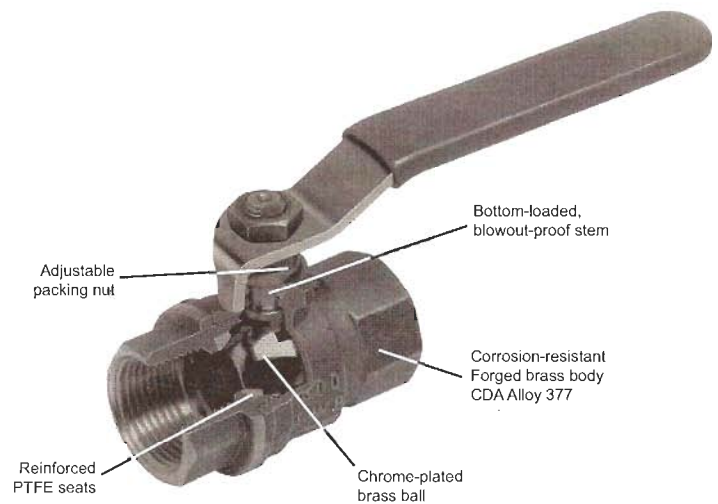
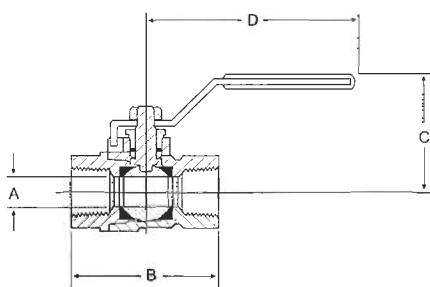

Materials (for all valves)

- Body:** Brass, Forged
- Stem:** Brass
- End Caps:** Brass, Forged
- Handle:** Steel, dacromet finish, vinyl grip
- Stem Seal:** Reinforced PTFE
- Thrust Washer:** Reinforced PTFE
- Ball:** Chrome plated
- Ball Seats:** Reinforced PTFE

Valve Size	VENTED LOCK-OUT	STANDARD MODEL	A	B	C	D	Cv
1/4	80021	80020	.32	1.77	1.56	3.23	6.0
3/8	80031	80030	.38	1.77	1.56	3.23	11.4
1/2	80041	80040	.59	2.32	1.73	3.94	19
3/4	80061	80060	.75	2.52	1.97	4.72	34
1	80081	80080	.95	3.19	2.13	4.73	52
1 1/4	-	80100	1.18	3.66	3.01	6.22	77
1 1/2	-	80120	1.50	4.02	3.25	6.22	143
2	-	80160	1.89	4.76	3.52	6.22	205